

KANANGOOR/Shimmer

Lawrence Wilson Art Gallery | 13 May – 19 August 2023

FLOOR MAP & LIST OF WORKS

Gallery Space A – Lawrence Wilson Art Gallery verandah and foyer

1. **Rickeeta Walley**, *Kanangoor*, 2023, composition and vocals: Rickeeta Walley; didgeridoo: Richard Walley; duration: 3 minutes. Commissioned for the *KANANGOOR/Shimmer* exhibition, The University of Western Australia, 13 May – 19 August 2023

Gallery Space B – Lady Sheila Cruthers Gallery

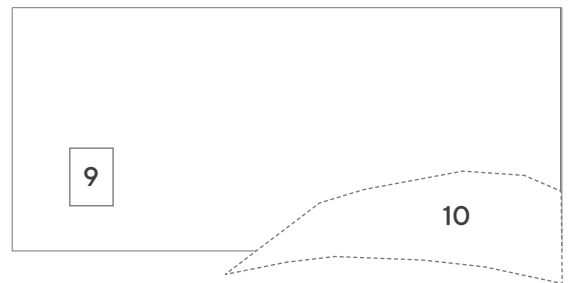
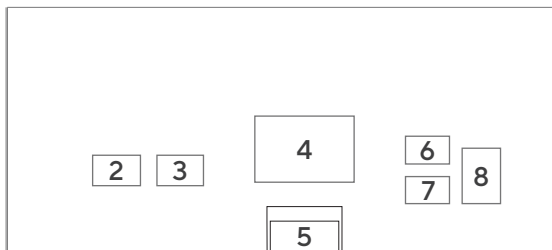

2. **Ben Pushman**, *Body Scars*, 2012, acrylic paint on canvas, 61 x 92 x 8cm. Berndt Museum 2019/0003, Gift of Dr. Ian and Sue Bernadt, 2018
3. **Christopher Pease**, *Down the rabbit hole II*, 2013, oil on canvas, 61.5 x 90.5cm. The University of Western Australia Art Collection, University Senate Grant and Gift of the Friends of the Lawrence Wilson Art Gallery, 2014
4. **Christopher Pease**, *Iconography*, 2001, acrylic on canvas, 130 x 180cm. The University of Western Australia Art Collection, Gift of Mr Donald Chequer, 2013
5. **Christopher Pease**, *Thoughts on first contact*, 2006, print, image: 40 x 60cm; sheet: 56 x 76cm. Berndt Museum 2007/0070, Donated by Wesfarmers, 2007
6. **Sandra Hill**, *Wardong in the loquat tree*, 2008, oil and acrylic on plywood panel, 91 x 100cm. Cruthers Collection of Women's Art, The University of Western Australia
7. **Sandra Hill**, *Stoker Hill*, 1996, printing ink, photographic materials and adhesive on paper, frame: 84.3 x 103.4 x 2.5cm. Berndt Museum 1996/0057
8. **Sandra Hill**, *Assimilation*, 2001, oil on canvas, 154.5 x 110.5cm. The University of Western Australia Art Collection, Gift of Mr Donald Chequer, 2013
9. **Yaluritja Clarrie Isaacs**, *Portrait of Mingli Wandjuri*, 1995, acrylic on canvas, 130.5 x 100.5 x 2.8cm. Berndt Museum 1996/0010
10. **Corey Khan**, *Nyitting*, 2023, site specific installation using vegetation (locally sourced on Noongar country), sand, model grasstree, artefact scatters, paperback, traditional rope reeds, kangaroo skins, dimensions variable. Commissioned for the *KANANGOOR/Shimmer* exhibition, The University of Western Australia, 13 May – 19 August 2023

Gallery Space C – Ruby Rose Maller Gallery



11. **Amanda Bell**, *...and the crow are we*, 2023, audio and video, organza, water, mirror, duration: 19 minutes 30 seconds, sound: Tom Allum; animation: Deanna Mosca (Dee). Commissioned for the *KANANGOOR/Shimmer* exhibition, The University of Western Australia, 13 May – 19 August 2023

Gallery Space D – Westpac Gallery

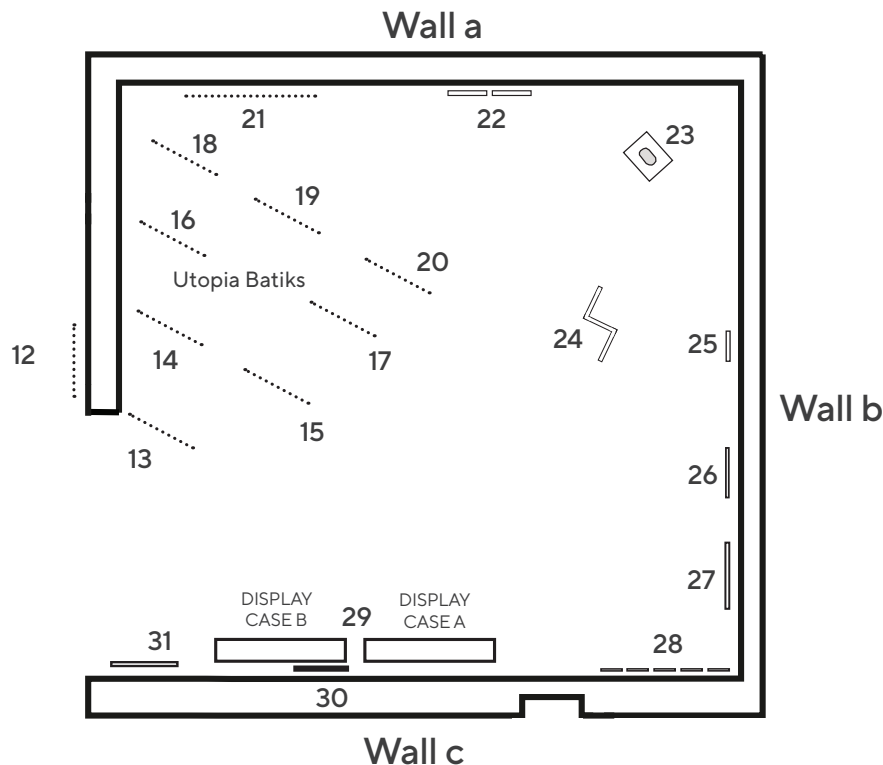

Utopia Batiks

- | | | |
|---|--|---|
| <p>12. Old Polly Gnale, <i>Arlparra Country</i>, c.1997, batik on silk satin with azoic dyes, 497 x 109cm, Cruthers Collection of Women's Art, The University of Western Australia</p> <p>13. Polly Nelson Gnale, <i>Blue tongue lizard and bush turkey</i>, c. 1997, batik on silk satin with azoic dyes, 464 x 115cm</p> <p>14. Rosie Kngwarre, <i>Kangaroo feed</i>, c.1997, batik on silk satin with azoic dyes, 464 x 114cm, Cruthers Collection of Women's Art, The University of Western Australia</p> <p>15. Ollie Kemarre, <i>Tree sprig design</i>, c.1997, batik on silk satin with azoic dyes, 461 x 111cm, Cruthers Collection of Women's Art, The University of Western Australia</p> | <p>16. Gloria Tamerre Petyarre, <i>Atnankere Story</i>, c.1997, batik on silk satin with azoic dyes, 465 x 114cm, Cruthers Collection of Women's Art, The University of Western Australia</p> <p>17. Joy Petyarre, <i>Grevilleas</i>, c.1997, batik on silk satin with azoic dyes, 460 x 114cm, Cruthers Collection of Women's Art, The University of Western Australia</p> <p>18. Jeannie Petyarre, <i>Alhalkere Dreaming</i>, c.1997, batik on silk satin with azoic dyes, 455 x 111cm, Cruthers Collection of Women's Art, The University of Western Australia</p> | <p>19. Nora Petyarre, <i>Yarumpa Dreaming</i>, c.1997, batik on silk satin with azoic dyes, 472.5 x 110cm, Cruthers Collection of Women's Art, The University of Western Australia</p> <p>20. Lena Skinner Gnale, <i>Bush tobacco flower and desert sand</i>, c.1997, batik on silk satin with azoic dyes, 476 x 114cm, Cruthers Collection of Women's Art, The University of Western Australia</p> |
|---|--|---|

Wall a

- | | | |
|---|--|--|
| <p>21. Gladdie Kemarre, Roese Pwerle, Nora Petyarre, Glory Gnale <i>Sydney silk, jointly worked at the Festival of Dreaming, September 1997</i>, batik on silk satin with azoic dyes, 118 x 291.5cm, Cruthers Collection of Women's Art, The University of Western Australia</p> | <p>22. Emily Kame Kngwarreye, <i>Untitled (Alhalkere)</i>, 1995, acrylic on pre-primed canvas, two panels, overall 191 x 168.4cm, Cruthers Collection of Women's Art, The University of Western Australia</p> | <p>23. Bethamy Linton, <i>King Brown</i>, 2013, hand-cut anodised titanium and sterling silver, 7.7 x 16.4 x 10.4cm. Private collection</p> |
|---|--|--|

Wall b

24. **Elisabeth Kruger**, *The collector*, c 1989, gouache and acrylic on wooden screen, 3 panels overall: 129 x 156cm. Cruthers Collection of Women's Art, The University of Western Australia
25. **Elisabeth Kruger**, *Sky with dripping pearl*, 1989, gouache and acrylic on board, 18 x 46cm, Cruthers Collection of Women's Art, The University of Western Australia
26. **Katie Breckon**, *Two Homes, Mitre Peak with Kimberley Stains*, 2018, pigment print on Hahnemuhle rag photographic paper, ed 2/10, 108 x 103cm. University of Western Australia Art Collection, University Senate Grant, 2018
27. **Barbara Haddy**, *Drift*, 1987, etching, aquatint, stencil from four zinc plates, number 4 from a unique state series of 6, sheet: 86 x 125cm. Cruthers Collection of Women's Art, The University of Western Australia

Wall c

28. **Danielle Freakley**, *To you (6-10)*, 2022, [suite of 5 sheets], watercolour on archival watercolour paper, 42.2 x 29.7cm each. Cruthers Collection of Women's Art, The University of Western Australia. Purchased through the Sheila Foundation Champions Circle, 2022
29. **Meta Overman** material on loan from the Reid Library Special Collections. Call Number: MS 175, Meta Overman Collection
30. **Meta Overman**, *Psyche*, performed at the Sydney Conservatorium of Music by 2019 Fellows of the Sydney Symphony Orchestra Program conducted by Roger Benedict with James Kortum (solo flute) and Jeanell Carrigan (piano); director - Narelle Yeo, 2019, video duration: 1 hour and 25 minutes
Provided with permission from Jeanell Carrington and Wirripang Pty Ltd
31. **Jody Quackenbush**, *Decadence II*, 2014, inkjet print in ornate gold frame, 96 x 119cm. Cruthers Collection of Women's Art, The University of Western Australia. Purchased through the Sheila Foundation Champions Circle, 2020

DISPLAY CASE A – META OVERMAN SURVEY

Correspondence 21st February 1964 Ansett-ANA regarding a ticket and congratulations on winning the Warringah Composers Competition, 1964

Ole Oogensluiter (Old Sandman) – Children's opera in 7 scenes. Libretto, after the well-known fairy tales of Hans Chr. Anderson (1 hand-written and 1 typed copy), 1924

Petaluma [The Mystic Chord] – Operare Mischievare in one act, 1968.

Grotesque – vinyl record, n.d.

Albany Choral Group Concert Programme 22 and 23 June 1954

Albany Choral Group Concert Programme Albany Town Hall Tuesday, 14 September 1954

Catalogue of Major Musical Compositions by Australian & New Zealand Composers by the Australasian Performing Right Association Ltd., n.d.

Aantekeringer over muziek by Meta Overman (Notes about music, singing techniques), n.d.

Biographical information compiled by Meta Overman, specifically the type-written document annotated "Ballett 4" which describes the writing of *Psyche* for performance in the Sunken Garden at UWA, c. 1955

Audio cassette featuring *Sonata for Viola and Piano*, *Seven Miniatures*, *Sonata for Clarinet and Piano*, *2 Dances for Piano Solo*, and *Island Songs*, c. 1965

Audio cassette featuring *The Artist and the Lady* and excerpts from *Psyche*, n.d.

DISPLAY CASE B – PSYCHE BY META OVERMAN

Photograph Meta Overman, taken in Holland prior to 1951 when Meta migrated to Australia. Meta is aged in her 30s-40s, c. 1951

Newspaper articles *Psyche*, 11 May 1955

8 Telegrams regarding *Psyche* February – March 1955

Festival of Perth January-February – March 1955 Programme *Psyche* (2 copies)

Pan en Psyche – 3-part suite for flute solo, 18 February 1948, Rotterdam.

Psyche – An Opera in Three Acts by Meta Overman, 1953

Recordings from cassettes

Recording of broadcast thought to be ABC Radio Melbourne approximately between 1963 and 1965.



Sonata for Viola and Piano,
Seven Miniatures, *Sonata for Clarinet and Piano*, *2 Dances for Piano Solo*



The Artist and the Lady and excerpts from *Psyche*

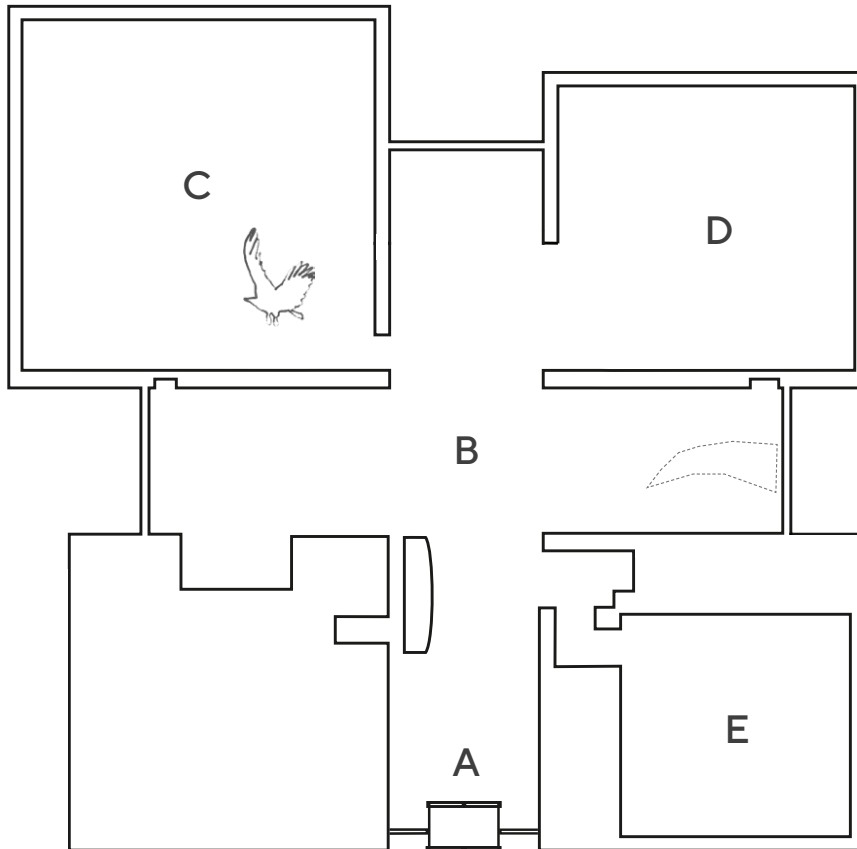

Gallery Space E – Janet Holmes à Court Gallery

The installation, *Wirringkirri*, by Joseph Williams Jungarayi, Jimmy Frank Japarula, and Lévi McLean, in the Janet Holmes à Court gallery, is curated by Jessyca Hutchens for the Berndt Museum. It was first presented as part of the exhibition *Black Sky* (2023) and will continue to accrete new meanings and elements as part of *KANANGOOR/Shimmer*.

Works exhibited from Nyinkka Nyunyu Art and Culture Centre; private collections; and University of Western Australia collections: Berndt Museum, The Cruthers Collection of Women’s Art, Reid Library – Special Collections and The University of Western Australia Art Collection.



KANANGOOR/Shimmer exhibition
curated by Amanda Bell and Lee Kinsella

website



LAWRENCE WILSON ART GALLERY
OPEN TUES - SAT 12 - 5PM
FREE ADMISSION
@LWAGallery

THE UNIVERSITY OF WESTERN AUSTRALIA
35 Stirling Highway, Crawley, WA, Australia 6009
P +61 (0)8 6488 3707 W uwa.edu.au/lwag
CRICOS Provider Code: 00126G



UWA SCHOOL OF
**Indigenous
Studies**

THE UNIVERSITY OF
WESTERN AUSTRALIA
**Berndt
Museum**